



**XHRL series**

**XHRL 12360W**



**Valve Regulated Lead Acid Battery**

Maintenance-Free Sealed Lead Acid Battery.  
Absorbent Glass Mat (AGM) technology for efficient gas recombination of up to 99%.

**General**

**Design for Standby Power Applications**

|  |   |
|--|---|
| <p><b>【Design Life】</b><br/>Up to 10 Years in Standby Service at 25°C<br/>Eurobat (20°C) : &gt;12 YEARS VERY LONG LIFE</p> <p><b>【Operating Temperature Range】</b><br/>Nominal Operating Temperature : 25°C (77°F)<br/>Discharge : -15°C ~ 50°C (5°F~122°F)<br/>Charge: -15°C ~ 40°C (5°F~104°F)<br/>Storage: -15°C ~ 40°C (5°F~104°F)</p> | <p><b>【Float Charging Voltage】</b><br/>13.5 ~ 13.8 VDC/Unit at 25°C (77°F)</p> <p><b>【Equalization Charging Voltage】</b><br/>14.4 ~ 15.0 VDC/Unit at 25°C (77°F)</p> <p><b>【Self Discharge】</b><br/>Less than 10% after 90 days, can be stored up to 6 months at 25°C (77°F); Fully recharging is required before usage, and charged sooner if stored at higher temperature than 25°C (77°F).</p> |
|--|---|

**Specification**

**Design according with IEC 60896-21/22:2004**

|                            |  |                                   |
|----------------------------|--|-----------------------------------|
| Nominal Voltage            | 12V (6 cells per unit)   |                                   |
| Nominal Capacity           | 360W @15min-rate to 1.67V per cell @25°C (77°F)                |                                   |
| Weight                     | Approx. 28.30 Kg (62.37 lbs)                                   |                                   |
| Maximum Discharge Current  | 800A (5sec)  |                                   |
| Internal Resistance        | Approx. 3.10 mΩ  |                                   |
| Short Circuit Current      | 2551A  |                                   |
| Maximum Charge Current     | 36A  |                                   |
| Terminal types             | I2 thread lead alloy terminal to accept M6 bolt                |                                   |
| Terminal tightening torque | 51.7±10.3 Kgf·cm / 44.9±9.0 Lbf·in / 5.1±1.0 N·m               |                                   |
| Container Material         | PP (UL 94-HB) & Flame Retardant (94-V0) available upon request |                                   |
| Dimensions                 | Length (L)   | 261.0±2.5 mm      10.28±0.10 inch |
|                            | Width (W)  | 168.5±2.0 mm      6.63±0.08 inch  |
|                            | Container Height (h)   | 210.5±2.5 mm      8.29±0.10 inch  |
|                            | Overall Height (H)   | 213.5±2.5 mm      8.41±0.10 inch  |
|                            |  |                                   |

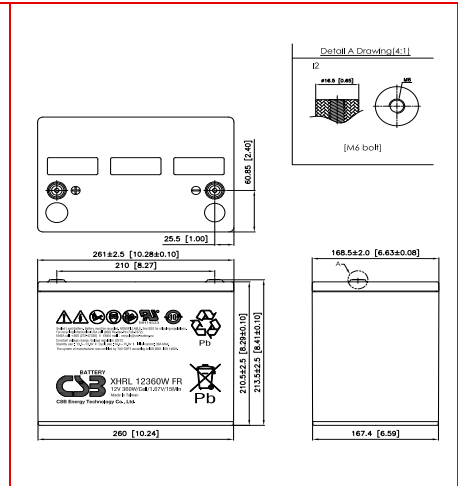

**Constant Current Discharge Characteristics Unit: A (25°C, 77°F)**

| F.V/Time | 2MIN | 4MIN | 5MIN | 6MIN | 8MIN | 10MIN | 15MIN | 20MIN | 30MIN | 45MIN | 60MIN | 90MIN |
|----------|------|------|------|------|------|-------|-------|-------|-------|-------|-------|-------|
| 1.60V    | 577  | 468  | 422  | 387  | 331  | 287   | 207   | 164   | 117   | 83.7  | 65.8  | 46.9  |
| 1.67V    | 524  | 421  | 386  | 360  | 308  | 272   | 200   | 159   | 116   | 82.8  | 65.2  | 46.6  |
| 1.70V    | 490  | 400  | 370  | 342  | 296  | 262   | 195   | 156   | 115   | 82.1  | 64.8  | 46.4  |
| 1.75V    | 438  | 364  | 334  | 310  | 275  | 240   | 185   | 150   | 111   | 80.3  | 63.7  | 45.9  |
| 1.80V    | 366  | 316  | 295  | 278  | 243  | 215   | 170   | 140   | 106   | 77.1  | 61.5  | 44.7  |
| 1.85V    | 294  | 272  | 254  | 235  | 208  | 189   | 150   | 126   | 97.8  | 71.6  | 57.4  | 42.0  |

**Constant Power Discharge Characteristics Unit: W (25°C, 77°F)**

| F.V/Time | 2MIN | 4MIN | 5MIN | 6MIN | 8MIN | 10MIN | 15MIN | 20MIN | 30MIN | 45MIN | 60MIN | 90MIN |
|----------|------|------|------|------|------|-------|-------|-------|-------|-------|-------|-------|
| 1.60V    | 5772 | 4683 | 4324 | 3949 | 3419 | 3001  | 2295  | 1836  | 1340  | 966   | 766   | 552   |
| 1.67V    | 5399 | 4381 | 4003 | 3701 | 3270 | 2864  | 2236  | 1799  | 1324  | 957   | 760   | 550   |
| 1.70V    | 5100 | 4198 | 3844 | 3577 | 3170 | 2783  | 2198  | 1774  | 1312  | 951   | 757   | 548   |
| 1.75V    | 4586 | 3834 | 3562 | 3355 | 2943 | 2617  | 2097  | 1708  | 1280  | 933   | 746   | 544   |
| 1.80V    | 4067 | 3454 | 3277 | 3047 | 2671 | 2411  | 1936  | 1601  | 1225  | 900   | 723   | 531   |
| 1.85V    | 3329 | 3038 | 2803 | 2625 | 2366 | 2184  | 1726  | 1453  | 1141  | 843   | 680   | 503   |

Please refer to the official site for the latest rating confirmation. URL: [www.csb-battery.com](http://www.csb-battery.com)

Issued: 200930

**Sales Offices**

**希世比能源科技股份有限公司**  
**CSB Energy Technology Co., Ltd.**

**BUSINESS HEADQUARTERS**

Tel: +886-2-2880-5600  
Fax: +886-2-2888-3300

**USA OFFICE**

Tel: +1-817-244-7777 / 1-(800)3-CSB-USA (272872)  
Fax: +1-817-244-4445

**SHENZHEN OFFICE (CHINA)**

Tel: +86-755-8831-6488/6775/6075  
Fax: +86-755-8831-6548

**EUROPE (EMEA) OFFICE**

Tel: +31(0)180-418-140  
Fax: +31(0)180-418-327

**SHANGHAI OFFICE (CHINA)**

Tel: +86-21-5046-1622/0833/0094  
Fax: +86-21-5046-1046

Recognized under UL 1989,  
and certified by ISO 9001, 14001, 45001, 50001.



**TAIPEI OFFICE**

Tel: +886-2-2880-5600  
Fax: +886-2-2888-3300

**BEIJING OFFICE (CHINA)**

Tel: +86-10-6597-8065/8165/8265  
Fax: +86-10-6597-8565